

Lopi DVL Direct Vent Gas Fireplace Insert



America's Favourite Fire

Lopi gas stoves and fireplace inserts have been America's favourite choice in fire for over twenty-five years. Our reputation for solid craftsmanship, reliable performance and unbeatable heating efficiency has been a winning combination year after year, and the favourite fire of families across the nation.

Lopi gas fireplace inserts are designed to turn your existing fireplace into an economical and beautiful heat source. You'll still enjoy a gorgeous fire without losing the heat out your chimney!

Our inserts feature designer faces for any decor and numerous finishing trims. Quiet blowers are standard in the DVL inserts and are designed to increase the heat transfer into your home. Remote controls or wall thermostat can also be added for hands free convenience and comfort.

The Lopi DVL, a perfect choice to convert your existing fireplace or new fireplace built from a non combustible material.

Features

- Approved convection space heater (high efficiency)
- Removable safety screen in front of glass.
- Patented Ember-Pyre™ Burner System
- Standard Wall switch included.
- Direct vent chimney system preserves indoor air quality.
- Shut-off valve included in fireplace.
- LP conversion kit included at no additional cost.
- Convection fan for increased heat transfers
- Variable door options
- Unique flexible flue designed for existing chimneys



Lopi DVL Direct Vent Gas Fireplace Insert

Specifications & Dimensions

- 40MJ per hour (high) NG/LP
- Heats up to 150sq metres
- Unit Height: 603mm
- Unit Width at Front: 800mm
- Unit Width at Back: 508mm
- Unit Depth: 368mm



PLEASE NOTE:
Electrical line positioned at the right hand side of the firebox (front view)

Gas Line positioned on the left hand side of the firebox (front view)

Optional Enhancements

- Multiple finish face options
- Multi-function remote control
- Wall Thermostat for complete hands-free operation
- Multiple Finishing Trims



Wall Thermostat



Remote Control

Multiple Surround Panels

Lopi offers 4 different ways to finish off your fireplace insert.

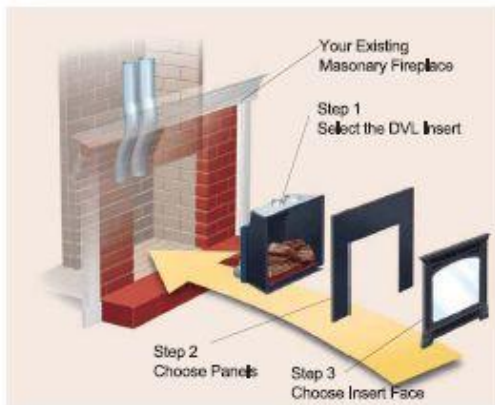

Rectangular Finish Panel
Can be modified to fit inside original fireplace



Rectangular Finish Panel
Available in 3 sizes
4 x 6" Panel: 737mm(h) x 1016mm (w)
8 x 10" Panel: 848mm (h) x 1122mm(w)
10 x 13" Panel: 924mm(h) x 1224mm(w)



Arch Finish Panel
Available in 2 sizes
8 x 10" Panel: 848mm (h) x 1122mm (w)



Rectangular Finish Panel
Offers a finish to fireplaces that are elevated. This panel will cover up to 7" (178mm)

Clearances to Combustibles

See owners manual for non-combustible clearances

Improper installation of your gas appliance or failure to operate it in accordance to the guidelines detailed in the Owner's Manual may negate your warranty and endanger your home and family. Installation information is available on our website at: www.lopi.com.au. We recommend all Lopi appliances be installed and maintained on an annual basis by your local authorised Lopi dealer.



wignells
of melbourne since 1949

THE HOME OF QUALITY HEATING & COOKING SYSTEMS

430 Johnston Street, Abbotsford, Vic. 3066
Specialising in French Fireplaces and servicing all of Melbourne
Visit their showroom to view their great range.

(03) 9417 3315 www.heatingmelbourne.com.au