



COMERAGH (DELUXE 90) (right)

Similar in function to the Errigal, in a more contemporary style and with the added benefit of warming cupboards .

Supplied with solid oven door & hot plate cover . Available in Mink as shown, Cream also available from mid 2009.

Domestic Hot Water or Non Boiler versions available. Available with or without Plate rack & Splashback .



- CAST IRON SOLID FUEL COOKERS -

ERRIGAL (TRADITIONAL) (left)

Tradition and style combined with modern function. Available in Senotherm matt black finish, or a variety of lustrous enamel colours - Cream, White or Black, with Forest Green also by special order.

Domestic Hot Water or Non Boiler versions available.

Optional hot plate cover & side trivets (shelves).

Available with or without Plate rack & Splashback .



UPDATED DONARD NOW AVAILABLE!

DONARD (SUPER STAR) (left)

With two ovens and a huge cooking surface the Donard is a magnificent centre piece for your kitchen. Supplied with solid oven door, hot plate covers, second oven and the option of a matching plate rack & splashback .

High Power (central heating) or Domestic Hot Water versions available.

Available in lustrous Cream, Forest Green, Mink, Black or Blue enamelled finish. Claret also available by special order



SUPERB STANLEY FEATURES:

- Luxurious Vitreous Enamel Finish In A Range Of Attractive Colours (Errigal also available in Senotherm black paint)
- Long Burning
- Powerful Central Heating (Donard only), Domestic Hot Water or Non-Boiler Models Available
- Cast Iron Oven(s) - second simmer oven in the Donard only
- Platerack & Splashback Option
- Self Cleaning Oven(s)
- Simple Finger Tip Controls
- Large Hot Plate(s)
- Insulating Hot Plate Covers (Donard & Comeragh, optional on Errigal)

FUEL: Seasoned & dry wood, coal or briquettes all burn effectively and efficiently. Consumption and cooker output will vary according to the calorific value and quantity of fuel used.

FLUE: Appropriate 152mm flue can be connected to either top or rear of cooker. Minimum length 3.6m.

CHOICE OF BOILER MODELS:

H.P.B. Donard (Central Heating) model has the capacity to service a central heating system with radiators rated to approximately 15kw when installed in conjunction with an average size hot water supply. The circulatory system should include an indirect 180 - 270 litre (40 to 60 gallon) hot water storage cylinder. All pipe fittings are 1" (25mm) flow & return. For summer use, or at other times when central heating is not required, the boiler output can be reduced by means of a "summer grate" to reduce the size of the firebox. Components are supplied with the cooker.

D.H.W. (Domestic Hot Water) unit is equipped with a boiler (2.5 litre capacity) designed to supply hot water to the bathroom & kitchen. The boiler has 1" (25mm) tappings at the rear of the cooker to connect to a 180 or 270 litre (40 or 60 gallon) direct (low pressure) water cylinder as recommended by the plumber. The boiler is stainless steel to resist corrosion. **Non Boiler & Domestic Hot Water versions available in all models.**

DIMENSIONS:

	Donard	Comeragh	Errigal
HEIGHT (mm) to top of platerack	1400	1420	1384
to hob level	890	915	876
DEPTH	600	600	617
WIDTH	920	890	914
WEIGHT	420kg	350kg	325kg
FLOOR PROTECTOR must protrude 300mm to front (all models)			
Required thickness	25mm	25mm	12mm

CLEARANCES TO COMBUSTIBLE SURFACES:

	Left	Right	Rear
Below Hob:			
Donard / Comeragh	35mm	35mm	25mm
Errigal	100mm	150mm	25mm
Above Hob:			
Donard / Comeragh	300mm	300mm	
Errigal	450mm	400mm	

Above clearances apply only to units with splashback fitted. See installation guide for further detail.

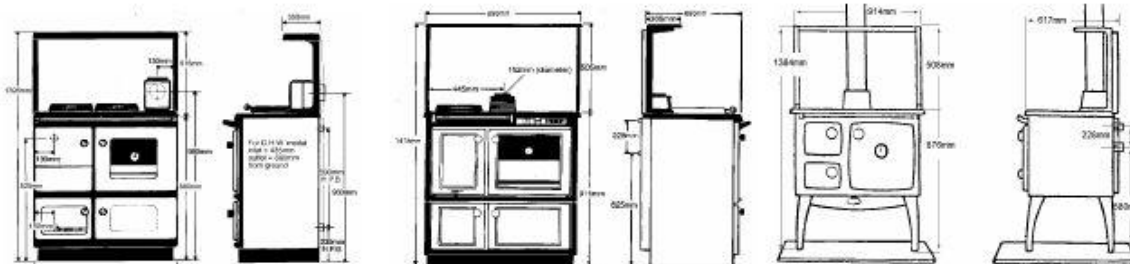

Donard (Super Star)

Comeragh (Deluxe 90)

Errigal (Traditional)



wignells
of melbourne since 1949

THE HOME OF QUALITY HEATING & COOKING SYSTEMS

430 Johnston Street, Abbotsford, Vic. 3066
Specialising in French Fireplaces and servicing all of Melbourne
Visit their showroom to view their great range.

(03) 9417 3315 www.heatingmelbourne.com.au