

heating technology since 1959



IAPMO-R&T



GasMark

GMK10050

AS4552

CONDENSING BOILER

RK 34/B

- Featuring the DIGITECH® 2 electronic board with digital display and evolved self-diagnostic utility
- Uses a condensing radial micro-flame primary exchanger
- Fitted with a primary (condensing) exchanger, microflame-radial-burner assembly and combustion chamber
- Strengthened stainless steel walls for better thermal insulation
- Fitted with a built-in 3-way valve
- Utilising the DUOPASS® system revolutionising the concept of boilers using the storage cylinder as an active component
- Compact boiler that at the same time guarantees very high performance
- Saves energy by not keeping water cylinders at the high temperature required by traditional boilers

Features:

- Diagnostics
- Modulation on the C.H. mode
- Adjustment of the C.H. temperature from 30°C to 80°C
- Adjustment of the C.H. maximum output
- Adjustment of the C.H. temperature for underfloor 25-40° C
- Sweep chimney control
- Frost protection
- Automatic by-pass
- Over-run protection of the circulating pump
- Over-run protection of the sanitary mode (B units)
- Anti-seize protection of the circulating pump
- Climatic regulation thru an outdoor sensor



External

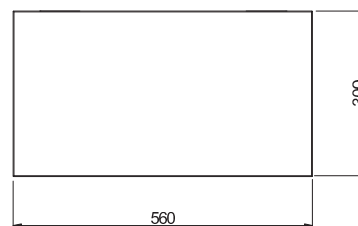
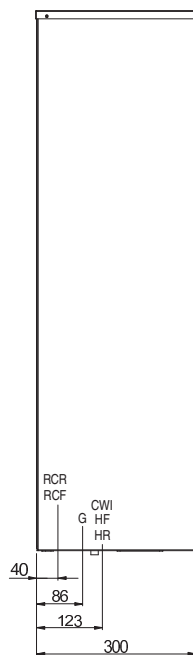
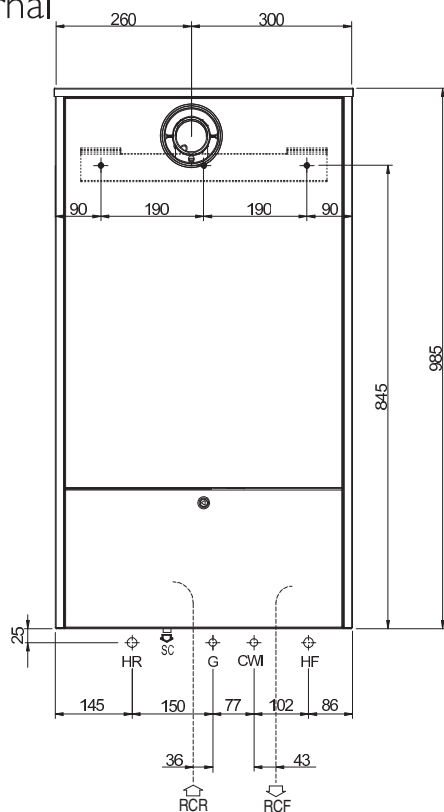

LEGEND

HR	HEATING RETURN	Ø3/4
HF	HEATING FLOW	Ø3/4
RCR	REMOTE D.H.W. CYLINDER RETURN	Ø3/4
RCF	REMOTE D.H.W. CYLINDER FLOW	Ø3/4
CWI	COLD WATER INLET	Ø1/2
G	GAS	Ø3/4
SC	CONDENSATE DRAIN	Ø25

Technical Features		RK 34 RK 34 / B
Output max. / min. (80/60°C)	kW	33,42 / 9,73
Output (50/30°C)	kW	36,24
Nominal input (sanitary mode)	kW	34
Efficiency @ 100% Pn / 30% Pn (80/60°C) (Gross)	%	98,3 / 100,7
Efficiency @ 100% Pn / 30% Pn (50/30°C) (Gross)	%	106,6 / 107,9
Expansion vessel - Capacity	l.	7
Electrical protection	IP	X4D
Overall dimensions (L x P x H) - Internal	mm.	410x310x730
Overall dimensions (L x P x H) - External	mm.	560x300x985

Internal

